



SINGLE-STAGE VACUUM GENERATOR INSTALLATION & OPERATION INSTRUCTIONS



WARNING



PLEASE READ THIS MANUAL COMPLETELY BEFORE USING THIS PRODUCT. SAVE THIS MANUAL FOR FUTURE REFERENCE AND KEEP IN THE VICINITY OF THE PRODUCT.

⚠ This is the safety alert symbol. When you see this symbol, personal injury is possible. The following signal words show the degree of injury.

Read this information carefully before proceeding.

- ⚠ **DANGER** Severe personal injury or death will occur if hazard is ignored.
- ⚠ **WARNING** Severe personal injury or death can occur if hazard is ignored.
- ⚠ **CAUTION** Minor injury or property damage can occur if hazard is ignored.

GENERAL INFORMATION

⚠ **DANGER** Do not pump flammable or explosive gases or operate in an atmosphere containing them.



Ambient temperature for normal operation should not exceed 125°F (52°C). Low atmospheric pressure at high altitudes reduces performance of this unit.

Materials used in construction of the single stage vacuum generator include anodized aluminum and brass. If unit will ingest substances other than air, consult local Gast representative for material compatibility.

INSTALLATION

⚠ **CAUTION** Supply pressure regulated air to inlet of vacuum generator. Excess pressure can cause parts to burst.

1. This Gast vacuum generator may be mounted in any position. Mounting holes are provided in aluminum body. Shock mounting is not required. Remove plugs from the IN and OUT ports
2. Connect a supply of clean, dry, regulated air to inlet port in aluminum head. Regulator setting should be between 30 and 70 psig (2-5 bar). Best setting is 68 psig (4,7bar). **NO LUBRICATION** should be used with Gast vacuum generators.

3. Vacuum connections to system must be equal or larger than port. Smaller piping will cause lower vacuum flows. Sealant should be used on all threads to prevent leakage. Be sure to keep excess sealant from being drawn into vacuum generator. Dusty or dirty applications should have a filter installed to prevent material from being drawn into generator.

⚠ **WARNING** Do not restrict exhaust air. This can cause vacuum port to become pressurized causing components to burst, resulting in injury or death.

4. Muffler supplied should be attached to exhaust port.
NOTE: Restricting outlet of this muffler, will reduce both flow and maximum vacuum.

OPERATION

⚠ **WARNING** Keep away from air stream. Solid or liquid material exiting the exhaust port can cause eye or skin damage.

To operate the vacuum generator, turn on the regulated air supply. Air flowing through unit causes vacuum to develop at intake ports. Material can enter vacuum generator either in compressed air stream or at vacuum port, it will be ejected through exhaust muffler.

After adjusting regulator and supplying inlet air, block off vacuum line to check for maximum vacuum. Reduced vacuum may be the result of system leaks. If this condition appears, check and seal leaks.

SERVICING

This Gast vacuum generator requires no scheduled maintenance. If performance drops, it may require cleaning. In most cases it is not necessary to remove vacuum generator from system.

⚠ **WARNING** Disconnect air supply and vent all air lines before servicing. Parts may burst if air is on when unit is disassembled.

1. Turn off or disconnect air supply.
2. Remove and clean muffler.
3. Remove and wash all parts in mild detergent and warm water to clean.
4. Reassemble in reverse order.

EXPLODED VIEW & PARTS ORDERING INFORMATION

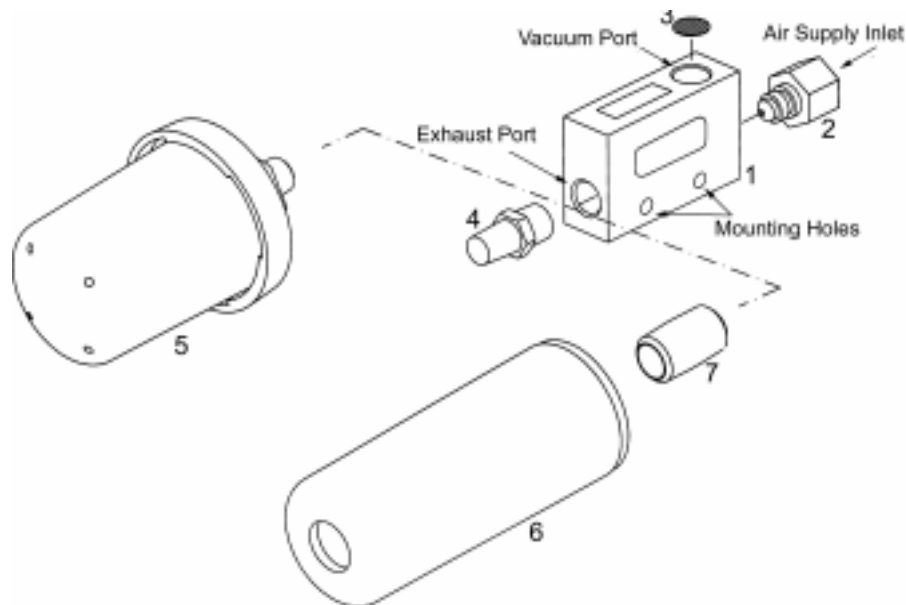

PARTS ORDERING INFORMATION

Ref No	Description	Qty	VG-007-00-00	VG-010-00-00	VG-012-00-00	VG-015-00-00	VG-017-00-00	VG-015-00-06
1	Body	1	VG2133	VG2106	VG2129	VG2037	VG2131	VG2046
2	Nozzle	1	VG2110	VG2107	VG2107	VG2042	VG2042	VG2047
3	Screen	1	VG2113	VG2113	VG2113	----	----	
4	Filter/Silencer (1/8" NPT)	1	VG2016	----	----	----	----	
5	Filter/Muffler Assembly	1	----	B300Q	B300Q	----	----	VG2127
6	Silencer	1	----	----	----	VG2045	VG2045	
7	Nipple	1	----	----	----	BA706A	BA706A	
	Filter Felt	3	----	B344A	B344A	----	----	B344A

For repair, we have Gast Certified Service Centers throughout the world. For the most up-to-date listing, contact one of our sales offices below:

World Headquarters
P.O. Box 97
2550 Meadowbrook Rd.
Benton Harbor, MI 49023-0097
Ph: 269/926-6171
FAX: 269/925-8288
www.gastmfg.com

European Sales & Service
Beech House Knaves Beech
Business Centre
Loudwater, High Wycombe Bucks,
England HP10 9SD
Tel: +44 1628 551500
Fax: +44 1628 551590
www.gastmfg.com

Gast Hong Kong
Unit 12, 21/F, Block B
New Trade Plaza
6, On Ping Street, Shatin
N. T. Hong Kong
Ph: (852) 2690 1008
Fax: (852) 2690 1012
www.gasthk.com



ISO 9001 & 14001 CERTIFIED

www.gastmfg.com